

**STEAB**

Via Ugo Corti, 18 - 50141 FIRENZE - ITALIA - Tel. 055-419988 r.a. - Fax. 055-419989 - www.steab.it

**ALLEGATO TECNICO**  
**Technical data sheet**

Codice documento:

**SC-ALLT Rev.0**

Rif./des.

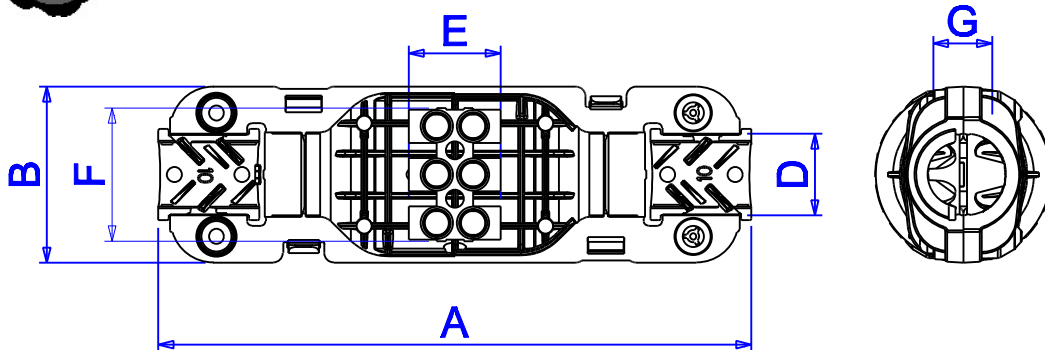
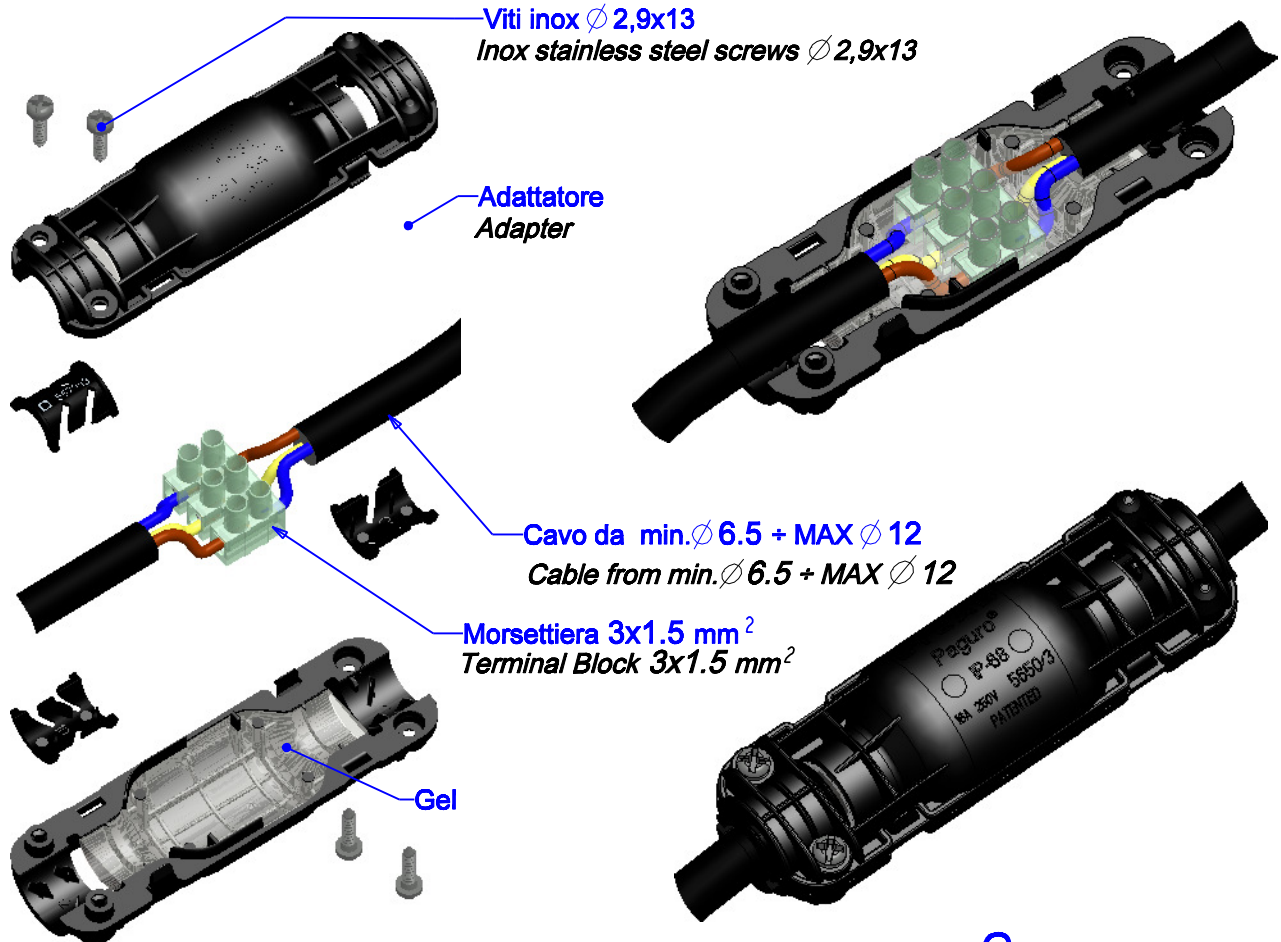
**Paguro® 5650\_3**  
**SCATOLA DI GIUNZIONE IP-68**  
**JUNCTION BOX IP-68****A3**Per cavi:  $\varnothing$  est. min. 6.5 + MAX 12 - For cables  $\varnothing$  ext. min. 6.5 + MAX 12

Codice Code	Dimensioni / Dimensions (mm)						Materiale Material →	Colore/Colour	
	A	B	D	E	F	G		2	...
<b>5650/3</b>	**	29	*	18.5	24	16		Nero Black	::

\*\* Se si utilizza per cavi da 9.5 a 12, A=95  
Se si utilizza per cavi da 6.5 a 9.5 A=100

Inseribile in un tubo di  $\varnothing$  interno min.30 mm  
A tube inserted in an internal min.dia.30 mm